



**HIGHLIFTER**

**SEIZMIK™**



✉ [info@falconridge.com](mailto:info@falconridge.com)

☎ 800-213-7981



[www.falconridge.com](http://www.falconridge.com)

Parts Available For These Popular Brands and Others

**POLARIS**

**can-am**



**HONDA**

**Kawasaki**

**YAMAHA**



## FALCON RIDGE

Born to help UTV owners outfit their vehicles for adventure, Falcon Ridge provides innovative, practical and rugged UTV products to give owners the confidence to explore.

***At Falcon Ridge, We're Fueled by Your Passion!***

Falcon Ridge Flash 4 Universal Turn Signal Kit  
Part Number 55-20608

If you are having any issues with your Falcon Ridge product, please reach out to Falcon Ridge customer service toll free 800-213-7981 or [info@falconridge.com](mailto:info@falconridge.com)

## Before You Get Started

### TOOLS NEEDED:

- Socket Wrench with 10mm Socket
- Small Philips Head
- Flathead Screwdriver
- Power drill with 15/32 drill bit
- Centerpunch/Awl

### PARTS LIST:

1. 55-20609 - Switch
2. 55-20610 - Mid Harness
3. 55-20611 - Short Extension Harness (2)
4. 55-20612 - Long Extension Harness (2)
5. 55-20613 - Falcon Ridge Left Indicator Light (2)
6. 55-20614 - Falcon Ridge Right Indicator Light (2)
7. 55-20615 - Hardware Kit
8. 54-90142 - License plate light (1)

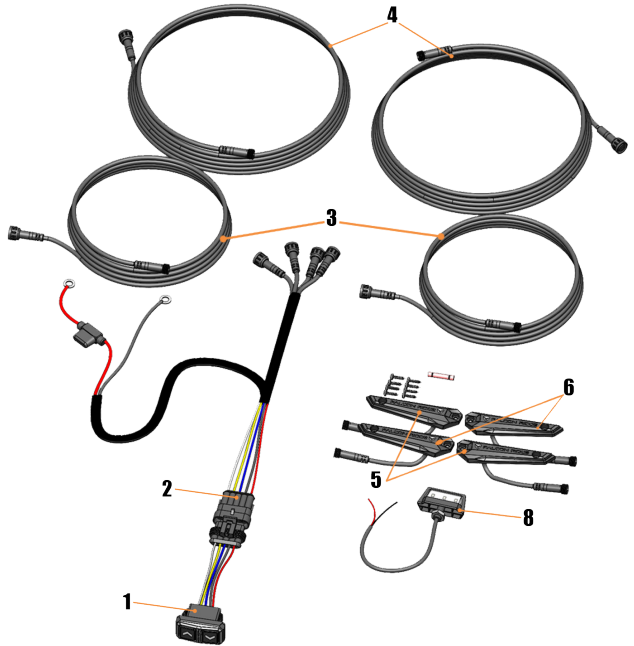

### IN HARDWARE BAG:

- A] M3.5 X 13 button head screw (8 ea)
- B] Heat shrink butt crimp (1 ea)
- C] Tape to wire insulation-piercing wire tap (1 ea)



## STEP 1: Place Template

TEMPLATE INCLUDED ON BACK PAGE

\* Images are of an install done on a polaris rZR xp1000.  
Steps are the same for the brand or model you are installing this kit on.



Place the indicator light template on the four corners of your vehicle where you deem fit. Make sure that the indicator lights are oriented correctly with the pointed tip aimed towards the outside of the vehicle, as shown in STEP B



Tape the template down in the desired positions to ensure holes are drilled in proper positions. Repeat process for each indicator light. Taping down templates will ensure symmetry between indicator lights prior to permanent placement.

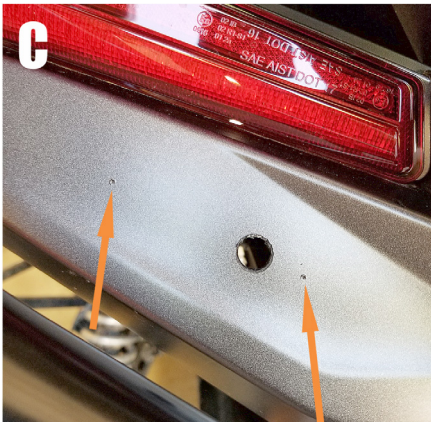

Use a centerpunch to mark the hole locations for the indicator lights. Repeat the process for the other indicator lights.



Use a 15/32 drill bit to drill the wire hole needed for the indicator lights. Repeat the process for remaining three indicator lights.

## STEP 2: Install Harness



Unfurl the Short Extension Harness and feed the wire through the front fender. Make sure the screw cap is facing forward towards the front of the vehicle. Repeat process for the opposite front fender.

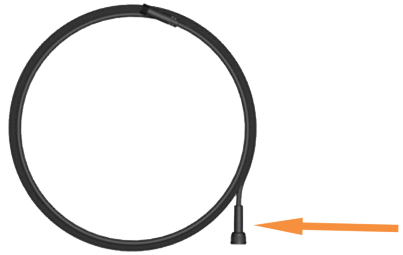

Unfurl the Long Extension Harness and feed the wire through the rear fender. Make sure the screw cap is facing forward towards the rear of the vehicle. Repeat the process for the opposite rear fender.

## STEP 3: Install Indicator Lights



Connect the indicator light(s) and Harness Extension(s). Pull the indicator light wire through the hole and screw the two wires together using the screw cap on the Harness Extension. Repeat the process for remaining three indicators.



Take the M3.5X13 mounting screws and use a small Phillips head screwdriver to attach the indicator lights to the vehicle. Repeat the process for remaining indicator lights.

## STEP 4: Install Switch

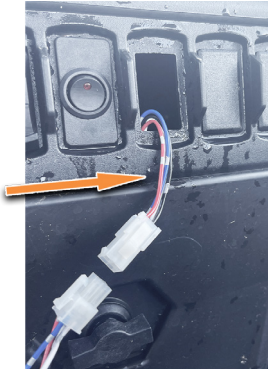

\*Wire connectors appearance may differ from the one shown.



Go into the cab of the vehicle and locate an unoccupied standard full-size rocker-switch mounting hole, (21.08mm X 36.83mm). If a cover is installed, remove the cover to allow for switch installation to proceed. If no cover is installed, feed the Mid Harness through the gap, female weather pack facing the rear of the vehicle.

Connect the female end of the Mid Harness and the male end of the Switch. Feed the remaining switch through the rocker-switch mounting hole and click the Switch into place. Ensure that the "FalconRidge" emblem is right-side up.

## STEP 5: Connect Power Source



Feed the pigtailed side of the Mid Harness through the grommet on the top portion of the firewall. Feed the positive, negative and auxiliary power cords through the grommet.



Connect the positive, negative and auxiliary power to your power source. A 10mm socket wrench will have to be used to remove and reattach the nut from the power source.

## STEP 6: Running the Long Extension Harness

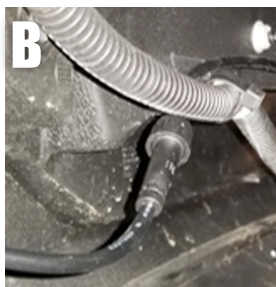
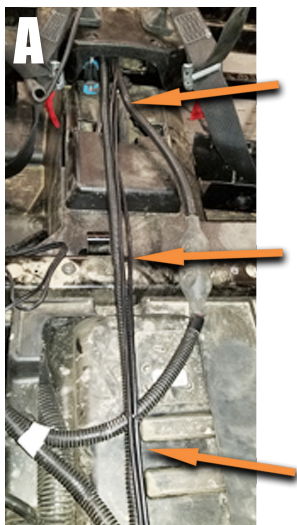

The rear passenger Long Extension Harness wire should be routed behind the engine towards the driver side Indicator light. This will make routing the wires to the front easier.

For running the Long Extension Harness to the front of the vehicle. There are two options to run the wires. If you want the wires to be hidden, is it best to run the wires down the length of the tunnel and up in front of the firewall (Shown). You can also run the wires down the side of the vehicle.



Run both the Long Extension Harness wires behind the frame on the driver's side and follow other wire harnesses as much as possible to avoid pinching and interference.



If a bench seat is installed, the bench seat needs to be removed to access the rear tunnel/back panel. Once completed, feed the Long Extension Harness through the tunnel. At this point, you can either continue to run the wires down the tunnel or out the side of the rear tunnel and to the side of the vehicle.



If running the Long Extension Harness through the tunnel and past the firewall, follow the main wiring harness up the front of the firewall.



Once at the top of the firewall, connect the Long Extension Harness to the Mid Harness. The longer of the two Long Extension Harness will need to be connected to one of the pigtails labeled "Driver". The other Long Extension Harness needs to be connected to one of the pigtails labeled "Passenger". Make sure to use the screw cap attached to secure the wires together.

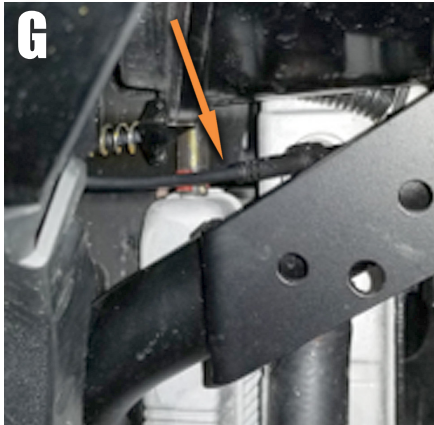

While at the front of the vehicle, feed the Short Extension Harness in front of the frame and up towards the Mid Harness. Once clear of interference, connect and secure the Short Extension Harness to the Mid Harness. Ensure that the driver side Indicator Light is secured to the appropriately labeled Mid Harness connector. Repeat the process for the opposite Short Extension Harness.

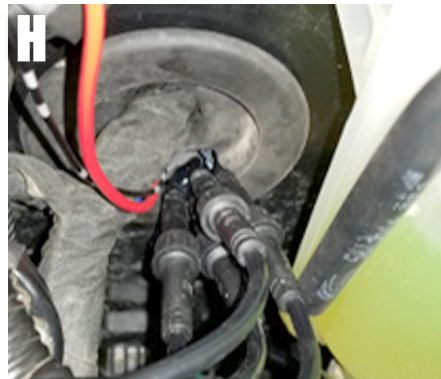

The end result of the pigtails should look like the above photo.



## STEP 7: Zip Tie Wires Together

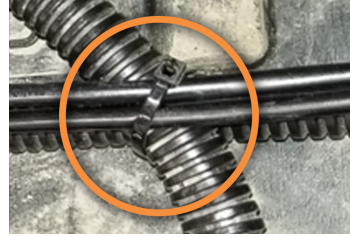
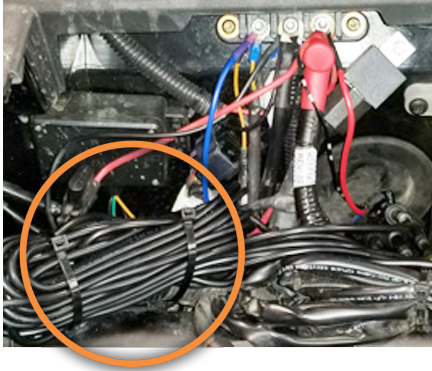

Once all cables are attached correctly. Zip-tie the remaining wires together and store in a safe place. Before driving your vehicle. Make sure that all wires are zip-tied and secured to the vehicle and will not interfere with operation.

## STEP 8: Optional

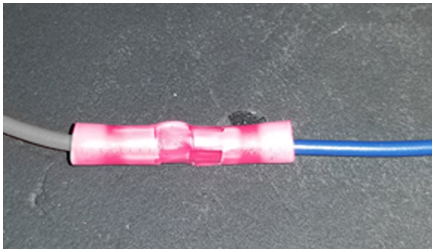

If you want to connect the auxiliary power for the Switch, please use the HSC to splice additional wire to the gray wire on the Switch.



If you want to connect the auxiliary power for the Switch and have a main wire that is already running to your power source; please use the Tap-To-Wire Insulation-Piercing Wire Tap to connect the two wires.

## STEP 9: Install License Plate Light

1. Locate where you'd like to install the light.
2. Drill an 11/32" Hole.
3. Push with wire through the hole until the light butts up to the surface you are mounting to.
4. Take the nut provided and slide it over the wire until you meet the threads on the light.
5. Thread the nut and tighten.
6. Connect the wires to your power source.

\*depending on mounting locations additional wire may be needed.

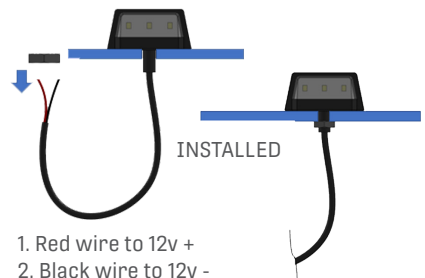

1. Red wire to 12v +
2. Black wire to 12v -

## TROUBLE SHOOTING

### **Indicators are not correct with switch?**

Find the faulty indicator extension wire and connected pigtail. Once found, switch the faulty indicator extension with the additional faulty indicator. Once secured, click the switch to make sure all indicators are correct.

### **Indicator is not flashing?**

Ensure that power is to the indicator is on and secured. If power is on and indicators are still not flashing, please call customer service at 800-213-7981 or at [info@falconridge.com](mailto:info@falconridge.com)



**FALCON RIDGE**

TEMPLATE ON REVERSE SIDE

# TEMPLATE

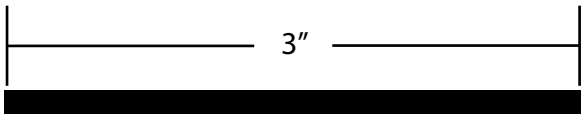
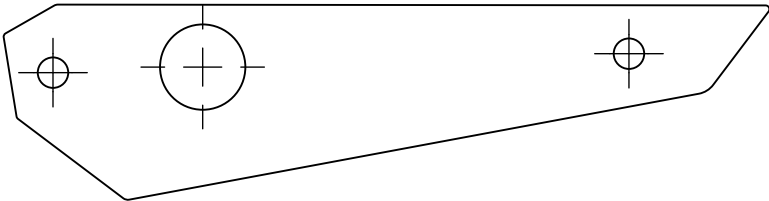
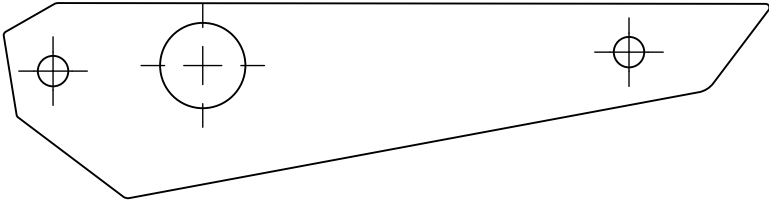
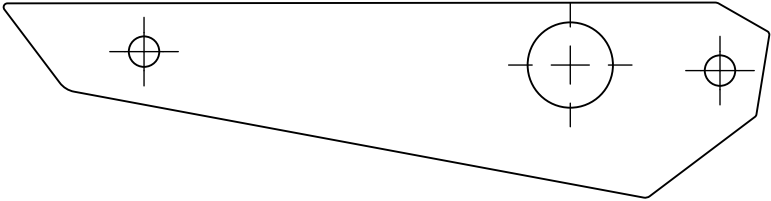
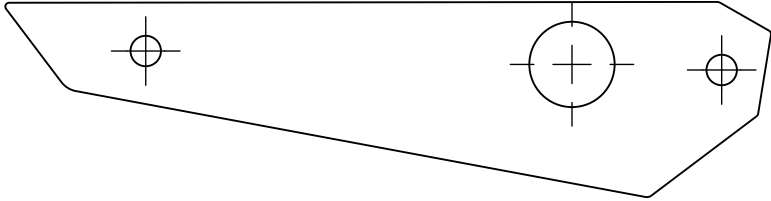

If printing instructions at home, measure the above bar with a ruler to make sure it is 3 inches.