

TRAILHEAD MIRROR - 56-19030
INSTALLATION MANUAL

PARTS LIST

Driver side Mirror

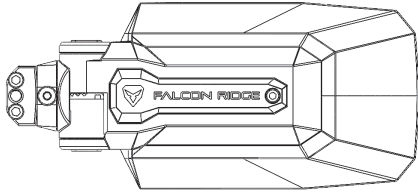

Passenger side Mirror

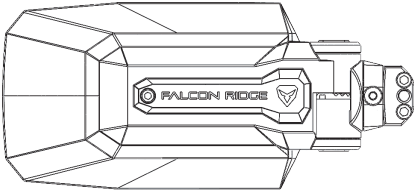

2.0" clamp assembly (2)

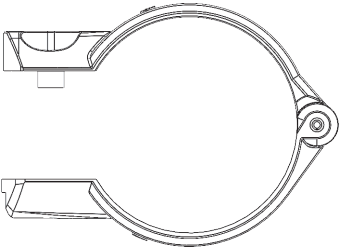

Rubber shim
(for 1.875" Cage)(2)

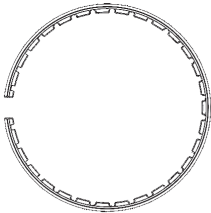

m6 x 25mm
socket head bolts (4)



m8 x16mm
socket head bolts (2)



m6 x12mm
button head bolts (4)

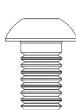

STEP 1

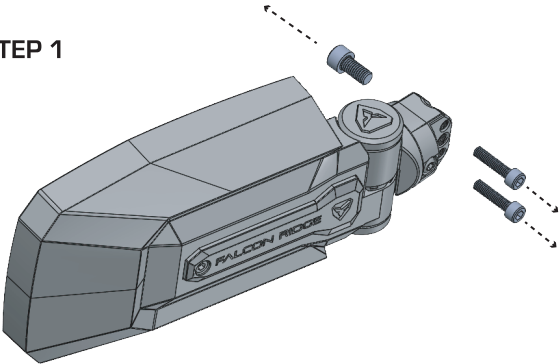

Disassemble 3 bolts by unscrewing.

STEP 2

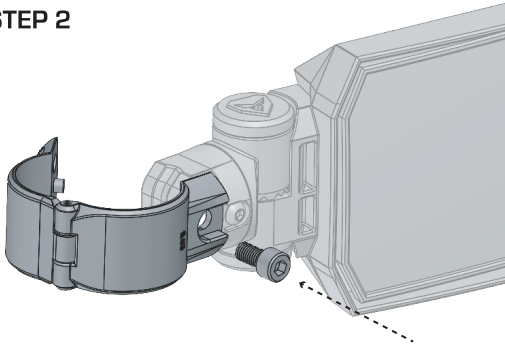

Assemble clamp using M8x16mm bolt.
DO NOT TIGHTEN IT ALL THE WAY YET.

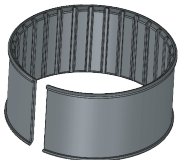

**Warning: *Only use
rubber shim on 1.875"
diameter tube.**

STEP 3

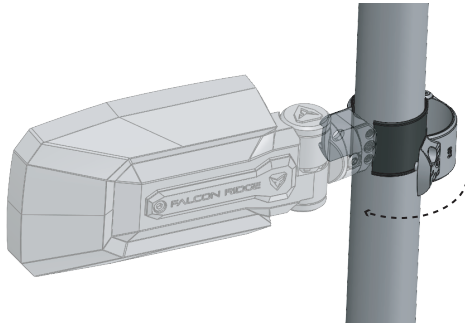

Open clamp and place around roll
cage tube. Close clamp around roll
cage tube. ***DO NOT use rubber
shim for 2.00" diameter tube.**

STEP 4

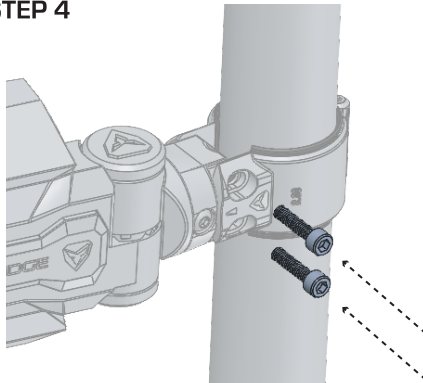

Complete the clamp assembly by
installing 3 m5x16mm bolts.
**DO NOT TIGHTEN THEM ALL THE
WAY YET.**

STEP 5

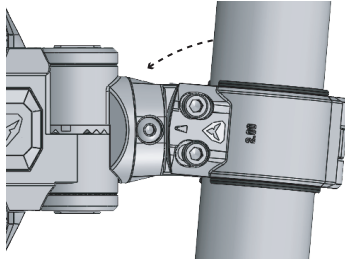

Rotate mirror on clamp so
that it is level and provides
desired viewing angle.

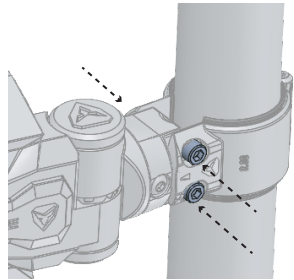

Tighten all 3 bolts to secure
the clamp on the roll cage
once adjustment is complete.

STEP 6

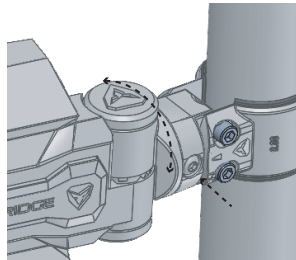

Loosen m6x12mm bolts to
rotate mirror housing for
desired angle. Retighten bolts
once adjustment is complete.

STEP 7

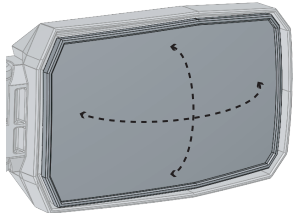

Adjust mirror tray by
pushing edges of the tray
for final adjustment.